

The Proposal



View Looking West from the Kingston Bridge



View looking South-West from the Western Slipway on the Kingston Bridge

Emerging PBSA Proposals

The emerging PBSA proposal seeks to develop a high quality student accommodation building, based largely within the envelope of the residential proposal, currently pending planning consent.

At this early stage GRAHAM Investment Projects seek to establish an early agreement on the principle of use, scale and mass with Glasgow City Council before progressing the more detailed aspects of the design.

The images opposite and above are white card model representations of the potential proposal. Materials have not been chosen at this time.

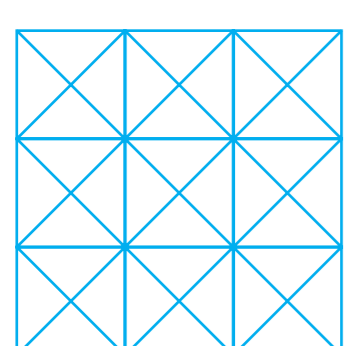

The Proposal

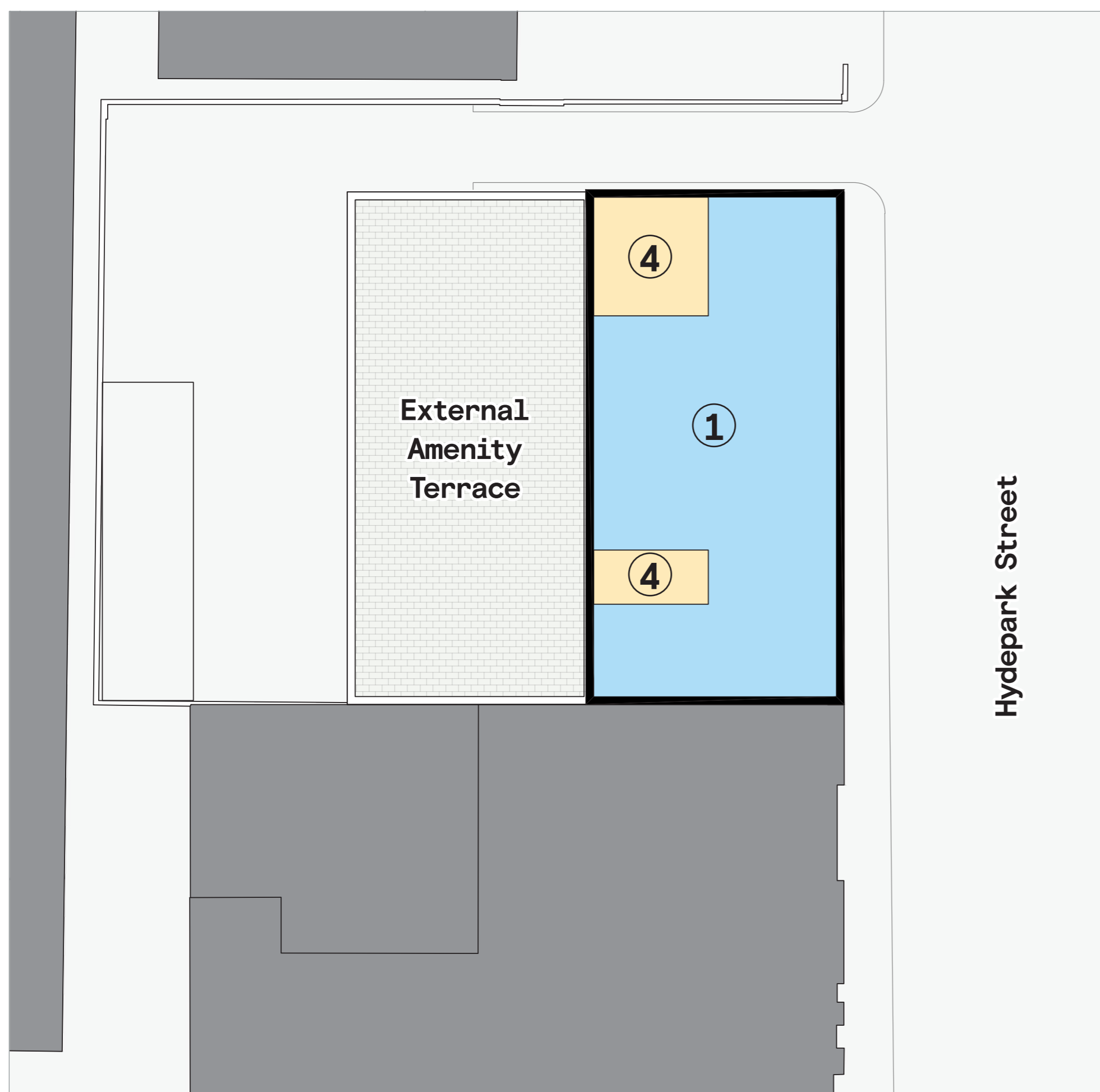

Block Plan - First Floor

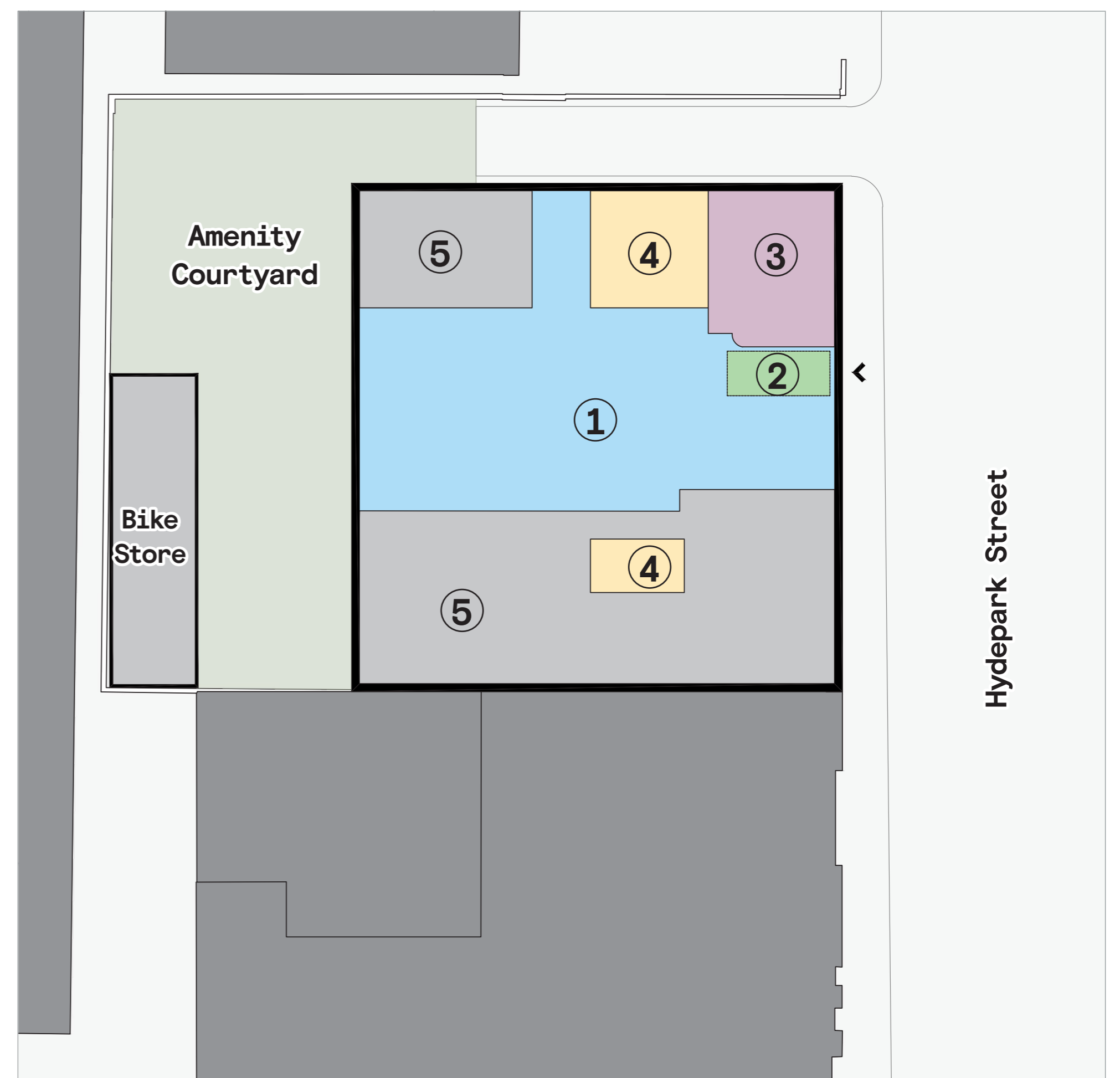

Block Plan - Ground Floor

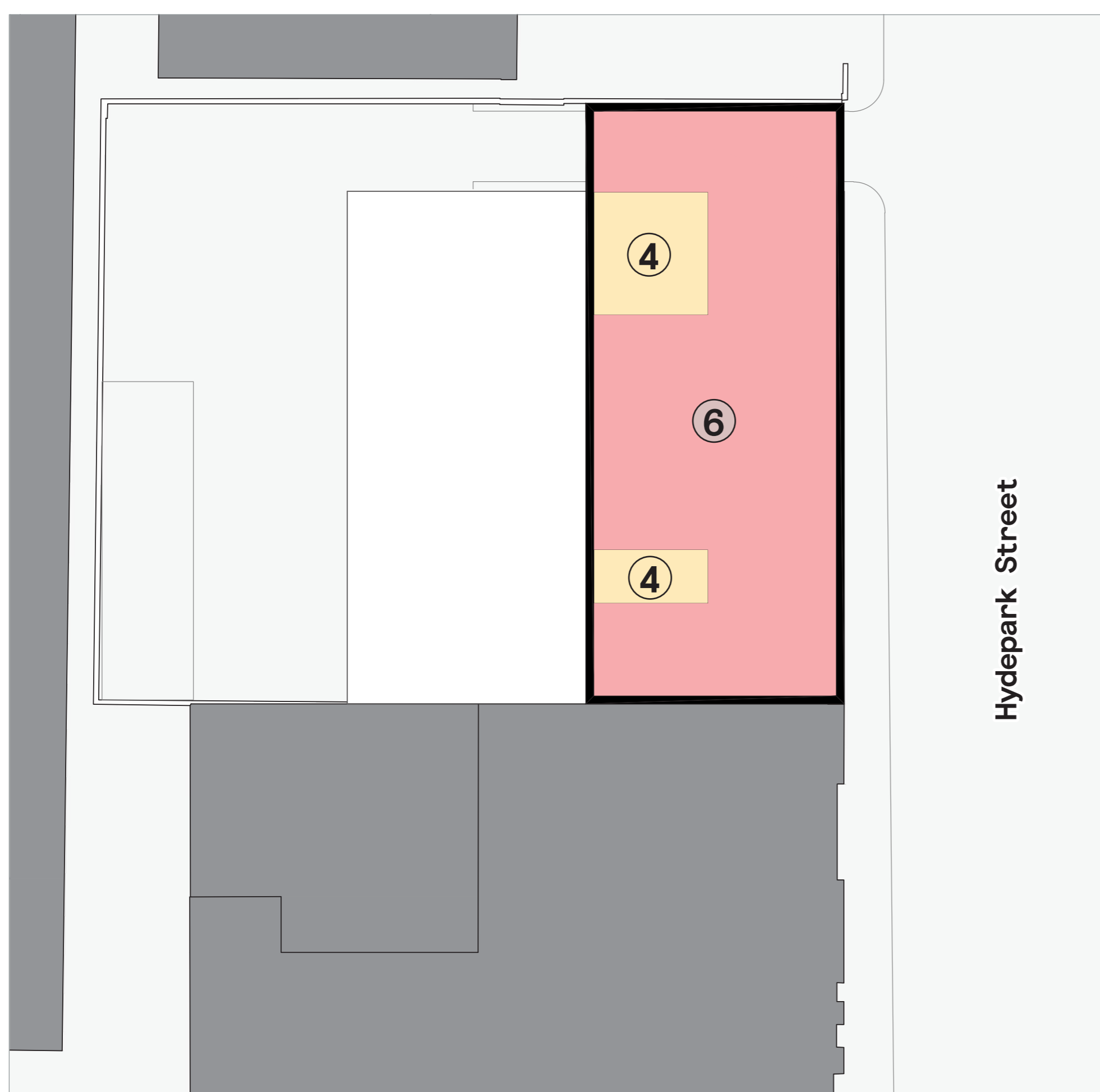

Block Plan - Typical Floor

Purpose Built Student Accommodation

The block plans show the emerging PBSA proposals. All residents are welcomed into a reception zone, with views through to the court space beyond.

Residential amenity will be designed across the ground, first and upper levels, animating the streetscape and providing excellent facilities for the residents. Back of house and plant uses are distributed to each side of the plans.

The typical floor shows the residential amenity levels with court and street views.

KEY

- | | |
|-----------------|-----------------------|
| ① Amenity | ④ Circulation Cores |
| ② Reception | ⑤ Plant |
| ③ Back of House | ⑥ Student Residential |

